



WyreStorm - Because the Technology Matters.

Introduction

Introducing the TS-280 to the WyreStorm range. The 2.8" colour touchscreen can control any product within the WyreStorm range; whether it be a presentation switcher or matrix. With ease of use in mind the TS-280 is as easy to use as it is to set up, with pre-configured UI's ready to upload in just seconds via the MicroSD card slot on the rear.

The UI's are simple to use with large buttons clearly labeled for each major function and navigation controls (where applicable) to move between pages. Using a standard RJ45 connection on the rear and RS-422 communication, the TS-280 also comes with an in-line RS-422 to RS-232 converter which doubles as a power-injector if used with a product that doesn't feed the 12v power.

Key Features

- 2.8" color touchscreen perfect for WyreStorm switcher control
- Backlit with automatic power off and wake on touch
- Pre-configured UI's designed for simple end-user experience
- Easy update: Download UI from wyrestorm.com and load via MicroSD card
- RJ45 connection and RS-422 communication to included RS-232 converter
- 300m/984ft transmission range to host device

	Touchscreen	Touchscreen Interface Module	
Audio and Video			
Switcher Control	1x RS-422: 8-pin RJ-45 Female	1x RS-232: 4-pin Phoenix	
Max Communication Distance	100m/328ft Interface to Touchscreen	15.24m/50ft Switcher to Interface	
Power			
Power Supply	12VDC from Touchscreen Interface Module	12V DC from switcher or separate PSU (not included)	
Max Power Consumption	0.84W	0.36W	
Environmental			
Operating Temperature	0 to +45°C (32 to +113 °F), 10% to 90%, non-condensing		
Storage Temperature	-20 to +70°C (-4 to +158 °F), 10% to 90%, non-condensing		
Maximum BTU	Transmitter: 24 BTU/hr Receiver: 58 BTU/hr		
Dimensions and Weight			
	TS-280-US	TS-280-EU	
Rack Units/Wall Box	2 Gang	2 Gang	<1U
Height With Without Feet	114mm/4.49in	86mm/3.39in	25mm/0.99in
Width With Without Brackets	117mm/4.61in	147mm/5.79in	80.2mm/3.16in
Depth With Without Handles	32.1mm/1.27in	32.1mm/1.27in	50mm/1.97in
Weight	0.30kg/0.66lbs	0.28kg/0.62lbs	0.14kg/0.30lbs
Regulatory			
Safety and Emission	CE FCC RoHS		

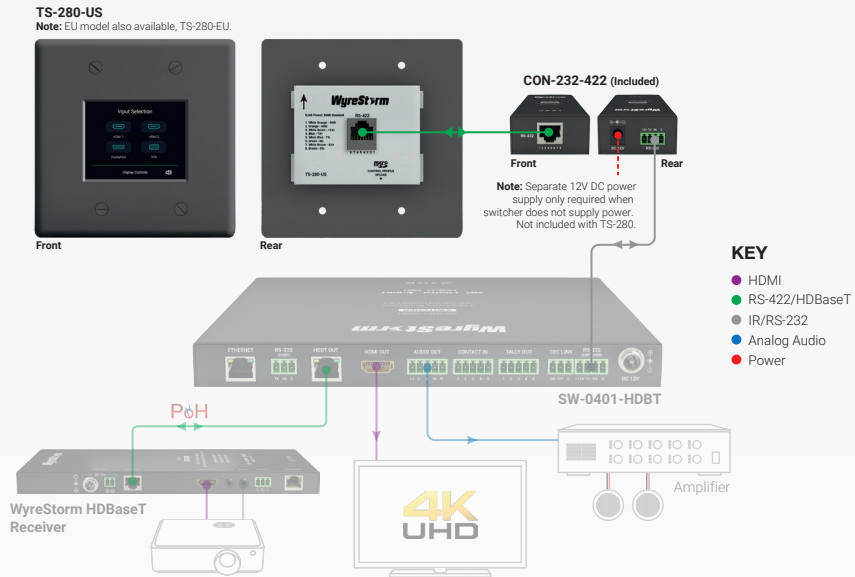

Note: WyreStorm reserves the right to change product specification, appearance or dimensions of this product at any time without prior notice.

3-Input In-wall HDBaseT™ Transmitter with USB Host & CEC Trigger. 2-gang US/UK Back-box

SW-130-TX-US | SW-130-TX-UK



Specification Sheet

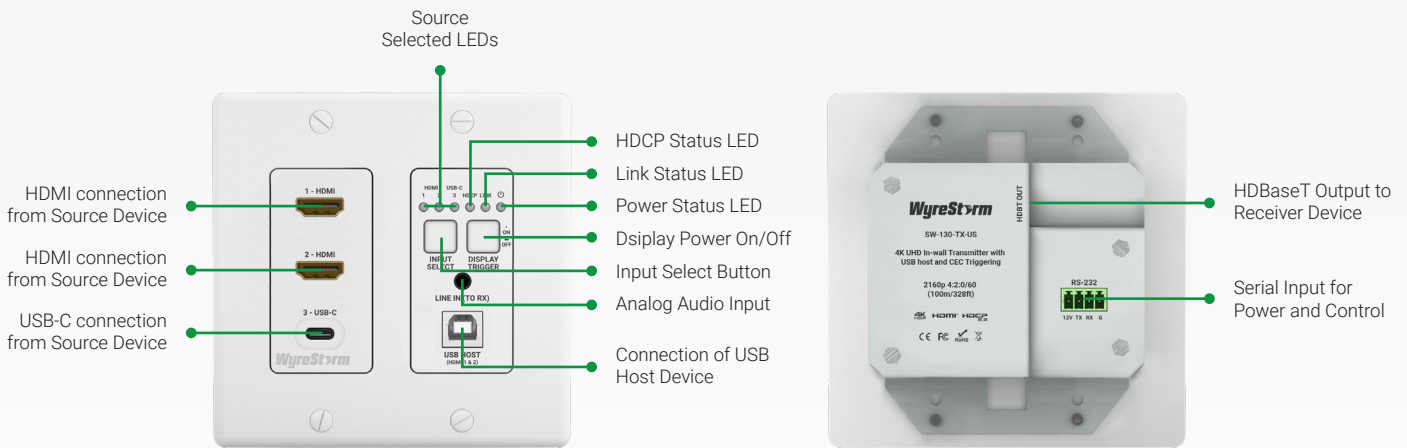

Note: All ports are identical on the SW-130-TX-UK model



WyreStorm - Powerful. Reliable. Simple.

Introduction

3 inputs and powerful HDBaseT transmission result in this powerful switching transmitter, perfect for corporate meeting and classroom environments. Automatic or manual switching of 2 HDMI's or USB-C and CEC power triggering via HDBaseT mean a simple user experience when it matters most. Further functionality allows USB devices to be routed back to the source via USB host (or natively via USB-C) and charging for the connected USB-C device.

Key Features

- Professional HDBaseT switcher/transmitter for video conference or meeting room
- 3-switchable inputs: 2 HDMI and USB-C supporting:
 - Content up to 4K/30 4:4:4 & RGB or 4K/60 4:2:0 8-bit
 - Latest HDR standards, including HDR-10 and Dolby Vision™ at 30Hz
 - HDCP 2.2 encryption technology ensuring compatibility with the latest 4K UHD content and sources
 - HD Multichannel audio up to DTS:X and Dolby Atmos™
- USB-C port supports alt-mode functionality for A/V and USB data
- USB-C charging for connected devices up to 5v 1A
- Compatible with DVI-I and DP++ v1.3 signals from supported devices
- Additional 2ch analog audio input for sending separate stereo audio to RX
- USB2.0 host port for connection of far-end devices such as webcams, smart touchscreens and microphones
- Automatic or manual CEC triggering for compatible connected screens or projectors
- Primary power supply via PoH from a supported receiving device (RX-700)
- Additional power input via DC port on rear via 12v 1A PSU (not included). Port shared with RS-232 input
- Control options include automatic switching, manual switching & CEC trigger and RS-232 control
- Compatible with TS-280 touchscreen for control with 12v power outlet
- 2-Gang UK form factor, white fascia, non-removable

For optimum performance, use with RX-700 4K HDR 4:4:4 60Hz HDBaseT2.0 Receiver with USB device inputs, Ethernet & PoH (4K: 100m/328ft)

In the Box

- 1x 4-pin Phoenix Male Connector
- 1x USB host cable (Type A-B)
- 1x Decora face plate (SW-130-TX-US)
- 4x Retaining screws (SW-130-TX-US)
- 1x Quickstart guide

Cat6 Cable Performance Guide

0m	10m	20m	30m	40m	50m	60m	70m	80m	90m	100m
0ft	32ft	65ft	98ft	131ft	164ft	197ft	230ft	262ft	295ft	328ft

■ 4K/HD Transmission

WyreStorm recommends the use of shielded cable to minimize signal noise and interference

Specifications

Transmission				
Transmission Encoding	HDBaseT Class C PAM16 Encoding			
End to End Latency	10µs			
Maximum Transmission Bit Rate	10.2Gbps			
Video				
HDMI	v2.0b TMDS 340MHz Maximum			
Inputs	2x HDMI In: 19-pin type A 1x USB-C In: USB 3.1c Audio/Video (4.5Gbps)			
Outputs	1x HDBT out: 8-pin RJ45			
Maximum Pixel Clock	HDMI & HDBaseT: 340MHz			
Video Resolutions (Max)	Video Resolution	HDMI	Cat6	Cat6a/7
	1920x1200p @60Hz	70m/230ft	70m/230ft	100m/328ft
	2560x1440p @60Hz	15m/49ft	100m/328ft	100m/328ft
	3840x2160p @30Hz 8bit 4:4:4	7m/23ft	70m/230ft	100m/328ft
	3840x2160p @30Hz 10bit 4:2:0 HDR	5m/16ft	70m/230ft	100m/328ft
	3840x2160p @30Hz 12bit 4:2:2 HDR	5m/16ft	70m/230ft	100m/328ft
Note: WyreStorm recommends the use of shielded category cable to minimize signal noise and interference.				
Supported Standards	DCI RGB HDR HDR10 Dolby Vision up to 30Hz HLG BT.2020 BT.2100			
Audio				
Inputs	1 x Audio In: 3.5mm (1/8in) TRS Stereo 2ch audio over HDBaseT 1-way to RX			
Audio Formats	2ch PCM Multichannel up to DTS-X and Dolby Atmos			
Maximum Sampling Rate	192KHz			
Maximum Audio Channels	32			
Audio Return Channel (ARC)	Not Supported			
Communication and Control				
USB Host (HDMI Inputs)	1x Type B host Maximum data throughput: 190Mbps			
USB 3.1c	Alt-mode Supported A/V and USB data from RX			
RS-232	1x RS-232: 4-pin Phoenix Shared with 12v DC input Compatible with WyreStorm TS-280 touchscreen via 4-pin phoenix port (only when using PoH)			
HDCP	Pass-through, 2.3 Supported			
EDID	Pass-through, from RX			
Consumer Electronics Control (CEC)	One-way display trigger to RX			
Auto Low Latency Mode (ALLM)	Supported			
Variable Refresh Rate (VRR)	Supported			
Power				
Power Supply	12V DC 1A (not included)			
Max Power Consumption	7.8W			
Power-over-HDBaseT (PoH)	Supported, 1-way from RX			
Local Power Supply Input	4-pin phoenix			
Environmental				
Operating Temperature	0 to + 45°C (32 to + 113 °F), 10% to 90%, non-condensing			
Storage Temperature	-20 to +70°C (-4 to + 158 °F), 10% to 90%, non-condensing			
Maximum BTU	2.29 BTU/hr			
Dimensions and Weight				
	SW-130-TX-UK		SW-130-TX-US	
Installation	In-wall, 2-gang		In-wall, 2-gang	
Height	86mm/3.38in		105mm/4.13in	
Width	146mm/5.74in		89mm/3.5in	
Depth	38mm/1.55in		38mm/1.55in	
Weight	0.27Kg/0.60lbs		0.3Kg/0.66lbs	
Regulatory				
Safety and Emission	CE FCC RoHS RCM EAC			

Right Product for the Right Application.

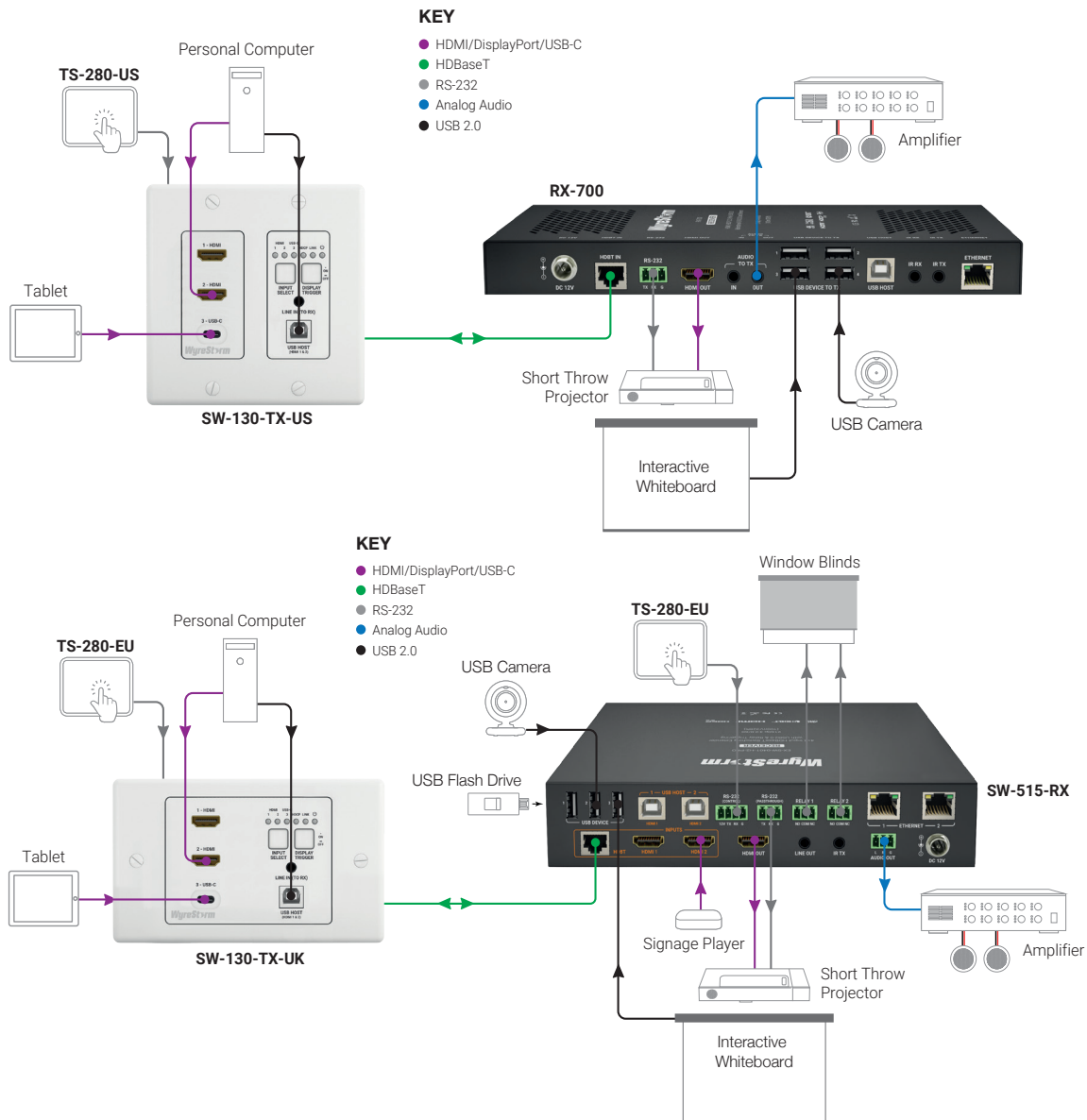

Note: WyreStorm reserves the right to change product specification, appearance or dimensions of this product at any time without prior notice.

4K HDR 4:2:0 60Hz HDBaseT2.0 Receiver with USB Device Inputs, Ethernet & PoH (4K: 35m/115ft)

RX-500

WyreStorm

Specification Sheet

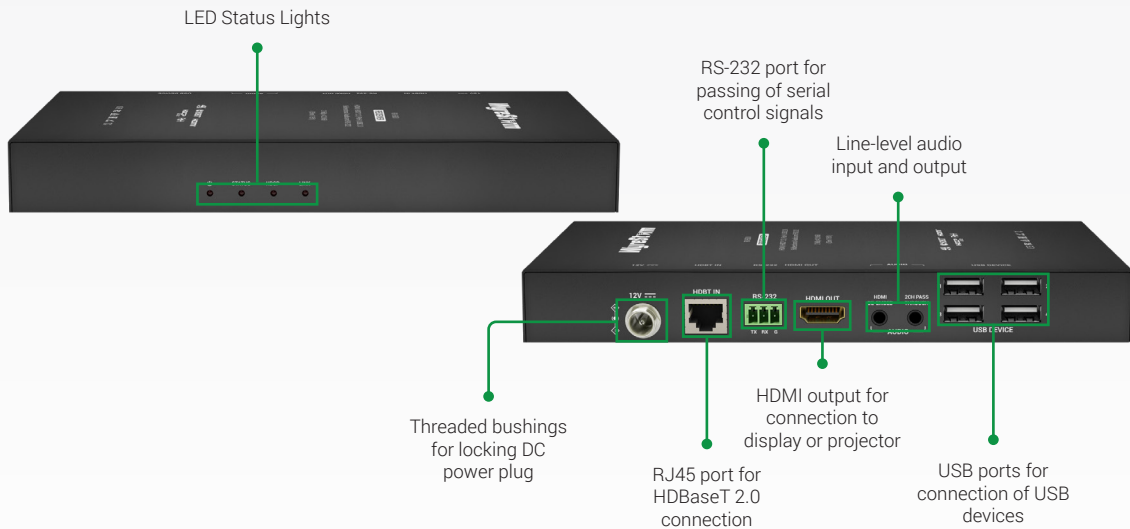

4K HDR 2160p 4:4:4 60 HDBaseT™ HDMI HDCP 2.2 PoH

WyreStorm - Powerful. Reliable. Simple.

Introduction

The little brother to the RX-700, the RX-500 also utilizes HDBaseT 2.0 technology extending 4K video, USB 2.0, audio and control point to point up to 35m/115ft. The RX-500 still maintains the ability send HID's and data back to the transmitter with USB 2.0 compatible devices such as HD webcams, smart white boards and data drives alike

Key Features

- HDBaseT Receiver supporting:
 - Content up to 4K/60 4:2:0 & RGB 8-bit
 - The latest HDR standards, including HDR-10, HLG and Dolby Vision at 30Hz
 - HDCP 2.2 encryption technology ensuring compatibility with the latest 4K UHD content and sources
 - HD Multichannel audio up to DTS:X and Dolby Atmos via HDMI
 - 2160p 4:2:0 60Hz HDR content from a source to a display or projector using HDBaseT up to 35m/115ft
- Compatible with DVI-I and DP++ v1.3 signals from compatible devices
- USB 2.0 passthrough offering 190Mbps transfer and HID extension
- Features 4 USB device ports
- Supports analog audio pass-through from transmitter to receiver
- Supports analog audio de-embed from HDMI output
- Bi-directional RS-232 and CEC pass-through communication
- Backwards compatible with HDBaseT 1.0 transmission and receiving devices (lowest denominator takes priority)
- PoH from RX>TX

In the Box

- 1x RX-500 Receiver
- 1x 12V DC 2A PSU with (US/UK/EU/AU)
- 2x Mounting Brackets with Screws
- 1x 3-pin Terminal Block
- 1x QuickStart Guide

Specifications

Audio and Video				
Inputs	1x HDBT In: 8-pin RJ-45 Female 4x USB Type A (Device)			
Outputs	1x HDMI Out: 19-pin type A 2x Audio Out/De-embed: 3.5mm (1/8in) TRS Stereo			
Output Video Encoding	HDBaseT Class B			
Encoding Data Rate	10.2Gbps			
End to End Latency	10µs (micro seconds)			
Audio Formats	HDMI Out: 2ch Analog/PCM Multichannel: LPCM up to DTS-X and Dolby Atmos Audio Out/De-embed: 2ch Analog/PCM			
Video Resolutions (Max)	Video Resolution	HDMI	Cat6	Cat6a/7
	1920x1080p @60Hz 12bit	15m/49ft	70m/230ft	70m/230ft
	3840x2160p @30Hz 8bit 4:4:4	7m/49ft	35m/115ft	35m/115ft
	3840x2160p @60Hz 8bit 4:2:0	7m/49ft	35m/115ft	35m/115ft
	Note: WyreStorm recommends the use of shielded category cable to minimize signal noise and interference.			
Supported Standards	DCI RGB HDR HDR10 Dolby Vision up to 30Hz HLG BT.2020 BT.2100			
Maximum Pixel Clock	297MHz			
Communication and Control				
HDMI	HDMI HDCP 2.2 EDID CEC Pass-through DVI/D supported with adapter (not included)			
HDBaseT	HDMI USB HDCP 2.2 EDID 1-way PoH (RX powers TX) Bidirectional RS-232 CEC			
RS-232	1x RS-232: 3-pin Phoenix			
USB	4x Type A (device) USB hub compatible Maximum: 7 devices, 23 endpoints Maximum uplink speed: 190Mbps			
Power				
Power Supply	12V DC 2A			
Avg. Power Consumption	8W			
Environmental				
Operating Temperature	32°F ~ 113°F (0°C ~ 45°C) 10% ~ 90%, non-condensing			
Storage Temperature	-4°F to ~ 158°F (-20°C ~ +70°C) 10% ~ 90%, non-condensing			
Avg. BTU	27 BTU/hr			
Dimensions and Weight				
Rack Units Wall Box	<1U			
Height	25mm/0.98in			
Width	210mm/8.26in			
Depth	90.2mm/3.55in			
Weight	0.46kg/1.01lbs			
Regulatory				
Safety and Emission	CE FCC RCM EAC RoHS			

Note: WyreStorm reserves the right to change product specification, appearance or dimensions of this product at any time without prior notice.